

N SERIES

1.5T - 3.5T

LI-ION ELECTRIC FORKLIFTS

UN forklifts are designed to excel in the most challenging environments with increased safety, enhanced cooling systems, reduced noise and vibration all with low maintenance. With refined performance at an affordable price, UN Forklifts reduce the total cost of ownership and provide reliable and efficient solutions to drive productivity in your operations.



MODEL		1.5T	2.0T	2.5T	3.0T	3.5T
GENERAL SPECIFICATIONS						
Load Capacity	T	1.5T	2.0T	2.5T	3.0T	3.5T
Load Capacity	Q(kg)	1500	2000	2500	3000	3500
Load Centre	mm	500	500	500	500	500
CHARACTERISTICS & DIMENSION						
Rated Lift Height	H3(mm)	3000	3000	3000	3000	3000
Free Lift Height	H2(mm)	100	100	100	100	100
Fork Size (LxWxT)	mm	920x120x35	1070x120x40	1070x120x40	1070x125x45	1070x125x50
Mast Tilt Angle (F/R, α°/β°)	deg	6°/12°	6°/12°	6°/12°	6°/12°	6°/12°
Length to Face of Fork	L1(mm)	2150	2380	2380	2475	2535
Overall Width	B1(mm)	1090	1150	1150	1225	1225
Mast Lowered Height	H1(mm)	2025	2055	2055	2070	2070
Mast Extended Height (With Backrest)	H4(mm)	4055	4070	4070	4070	4070
Overhead Guard Height	H5(mm)	2125	2125	2125	2125	2125
Turning Radius	Wa(mm)	1995	2080	2080	2215	2280
Fork Overhang (Wheel Center to Fork Face)	X(mm)	409	478	478	485	485
Front Tread	B2(mm)	890	970	970	1000	1000
Rear Tread	B3(mm)	920	950	950	980	980
Ground Clearance		110	120	120	130	130

ISUZU



Market leading engines ensure superior performance, durability and excellent fuel efficiency. All diesel forklifts have Mitsubishi or Isuzu engines. The LPG and gasoline forklifts utilise Nissan engines.

MODEL		1.5T	2.0T	2.5T	3.0T	3.5T
Wheelbase	Y(mm)	1380	1500	1500	1600	1600
Fork Spread (Min/Max)	mm	140/970	250/1040	250/1040	250/1100	250/1100
Working Aisle Width With Pallet (1000x1200,1200 Lengthways)	Ast(mm)	3605	3830	3830	3970	4035
Working Aisle Width With Pallet (800x1200,800 Lengthways)	Ast(mm)	3805	3960	3960	4100	4165
TYRE						
Tyre (Front x 2)	mm	6.50-10-10PR	7.00-12-12PR	7.00-12-12PR	28x9-15-12PR	28x9-15-12PR
Tyre (Rear x 2)	mm	5.00-8-8PR	18x7-8-14PR	18x7-8-14PR	18x7-8-14PR	18x7-8-14PR
PERFORMANCE						
Travel Speed (Full Load)	km/h	12	12	12	12	12
Travel Speed (No Load)	km/h	13	13	13	13	13
Lifting Speed (Full Load)	mm/sec	280	300	300	280	280
Max.Gradeability (Full Load)	%	16	18	18	16	12
Max.Gradeability (No Load)	%	18	20	20	18	13
WEIGHT						
Total Weight (Include Battery Box)	kg	3060	4160	4420	5160	5420
POWER & TRANSMISSION						
Diver Motor	kw	7.5	11	11	12	12
Pump Motor	kw	10	12	12	13.5	13.5
Battery(standard)	V/Ah	51.2/300	51.2/405	51.2/405	83.2/405	83.2/405
Controller Type		AC	AC	AC	AC	AC
Controller Manufacturer		ZAPI	ZAPI	ZAPI	ZAPI	ZAPI
Operating Pressure	Mpa	14.5	17.5	17.5	17.5	17.5
EXTRAS INCLUDED						
Side-Shift		•	•	•	•	•
Fork positioner		•	•	•	•	•
Solid Non-Marking Tyres		•	•	•	•	•

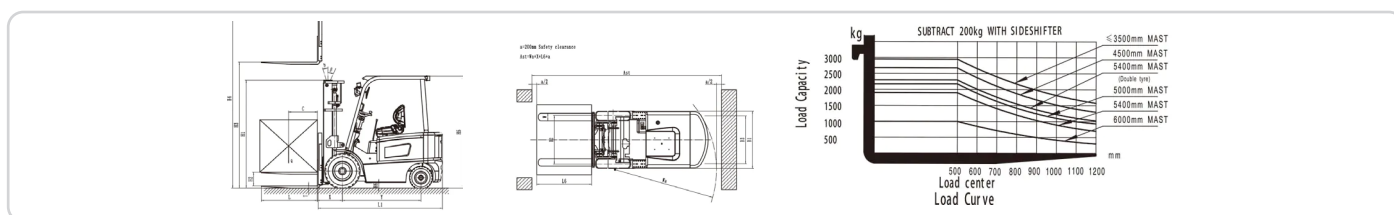

Market leading engines ensure superior performance, durability and excellent fuel efficiency. All diesel forklifts have Mitsubishi or Isuzu engines. The LPG and gasoline forklifts utilise Nissan engines.